

NH Heaven Gallery

Residential / Commercial Building

📍 Barwadda



M/S Aditya Builder

Office - Kusum Vihar Enclave, Kusum Vihar, Koyla Nagar, Dhanbad - 826005

Mob - 8864031266 , 7004947294



RESIDENTIAL BLOCK

Area Calculation

Flat	BUILTUP AREA (Sq.Ft.)	SUPER BUILTUP AREA (Sq.Ft.)
A	1215	1458
B	980	1176
C	1090	1325

PARKING AND OTHER CHARGES

Parking	2,00,000
Generator	30,000
Electrical Charges	30,000
Fire Safety	40,000

PAYMENT SCHEDULE

- At the time of booking. 20%
- At the time of Commencement of Structure. 20%
- At the time of Book roof Casting. 20%
- At the time of Commencement of Brick Works. 20%
(e.g. plastering, flooring)
- At the time of Finishing. 15%
- Before the Delivery of Possession 05%

Note: GST as per applicable

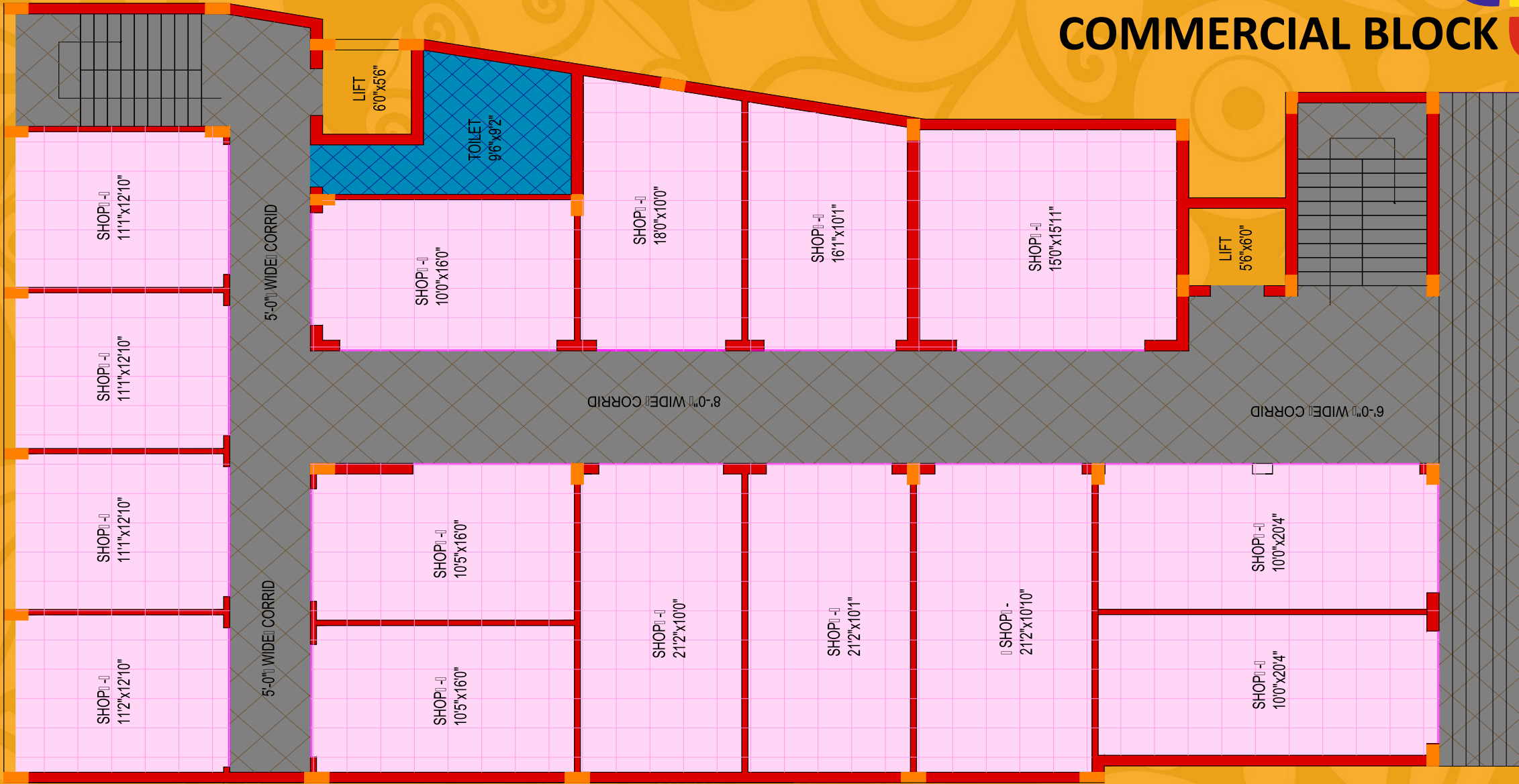

AREA STATEMENT

SHOP No	SHOP 1	SHOP 2	SHOP 3	SHOP 4	SHOP 5	SHOP 6	SHOP 7	SHOP 8	SHOP 9	SHOP 10	SHOP 11	SHOP 12	SHOP 13	SHOP 14	SHOP 15
BUILTUP AREA (Sq.Ft.)	233	225	256	237	236	188	188	170	160	160	163	184	205	183	280
S.BUILTUP AREA (Sq.Ft.)	326	315	359	332	330	263	263	237	224	224	228	257	288	257	392

GENERAL SPECIFICATION

- Structure** : R.C.C. framed structure with brick work with cement, as per design & specification of structure consultant.
- Chaukhat** : Door frame (Choukhat) Salwood.
- Door** : Flush door shutter of 32 mm thick ISI
- Window** : Fully glazed aluminum sliding windows with grill.
- Kitchen** : (a) Flooring: Vitrified tiles (2x2).
(b) Working platform: granite tiles .
(c) Dado: 24" height glazed tiles.
- Flooring** : Flooring/Vitrified tiles (2x2).
- Lift** : One manual passengers lift in Residential block & Two lift in Commercial block.
- Stair Landing & Steps** : Granite/Marbles with steel Railing.
- Electrical** : Concealed copper wiring switches and fitting of reputed brand (anachor etc.)
- T.V. Plug Point** : One T.V. Plug provided in drawing room.
- 15 APP** : One in kitchen, drawing, M.BR & Toilet
- Internal wall finish** : All internal wall shall be finished by putti with a coat primer.
- Toilet** : High Quality Hindware / Parryware / Essco / Jaguar and ISI mark Sanitary fitting of economy range and Concealed GI fitting, 6ft ceramic tiles on Dado, Geyser Point, hot & cold water point white WC basin, Shower.
- Sanitary ware** : White sanitary ware fitting of reputed brand.
- Generator Set** : 500 watt power back up to each flat & 24 hours power supply for lift.
- Parking** : Adequate space available at extra cost.
- Note** : Extra accommodation with extra charges

Location Map

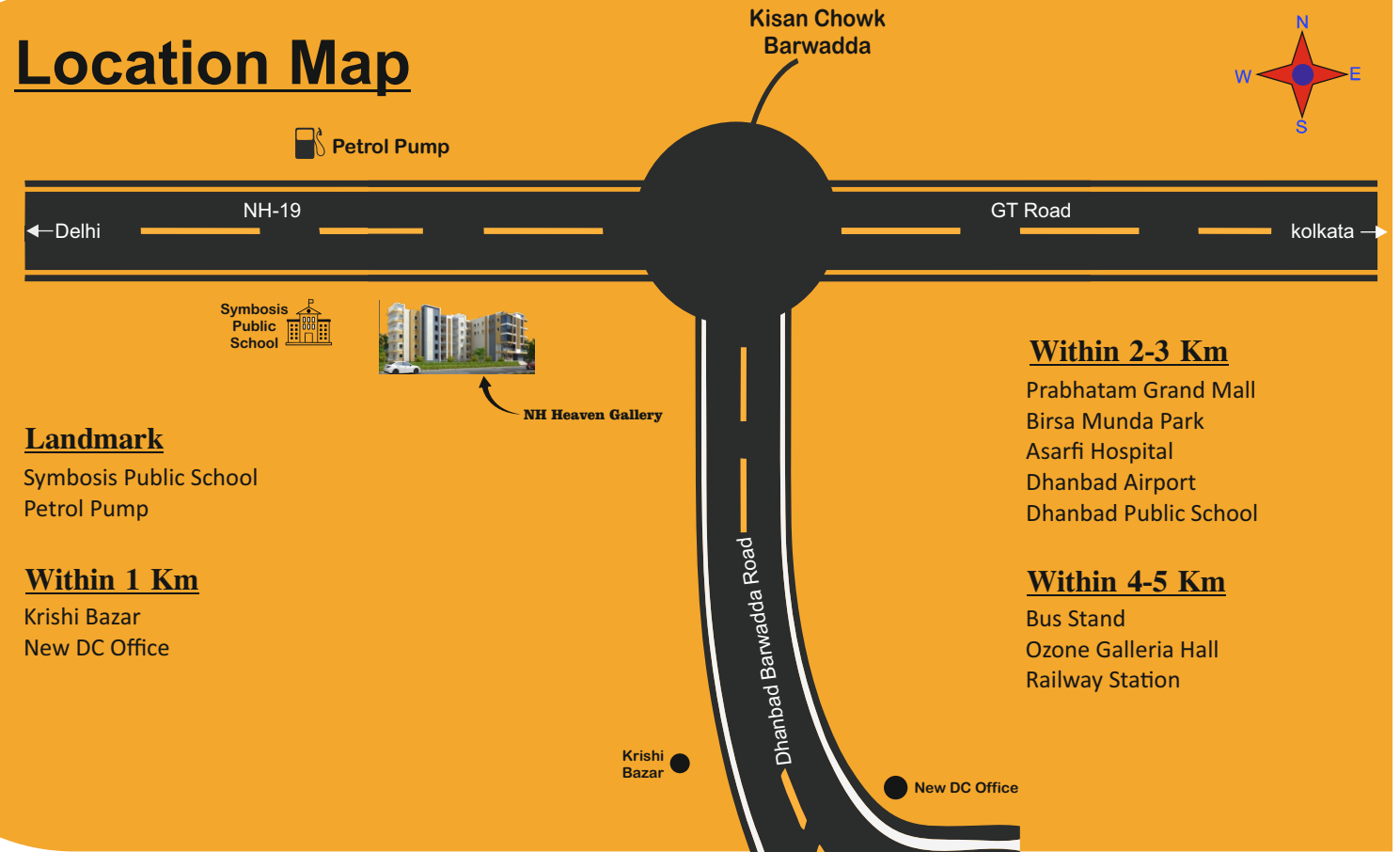

M/S Aditya Builder

Office - Kusum Vihar Enclave, Kusum Vihar, Koyla Nagar, Dhanbad - 826005

Mob - 8864031266 , 7004947294