

1431

Sanjivnara Nath

1319

2000Rs.

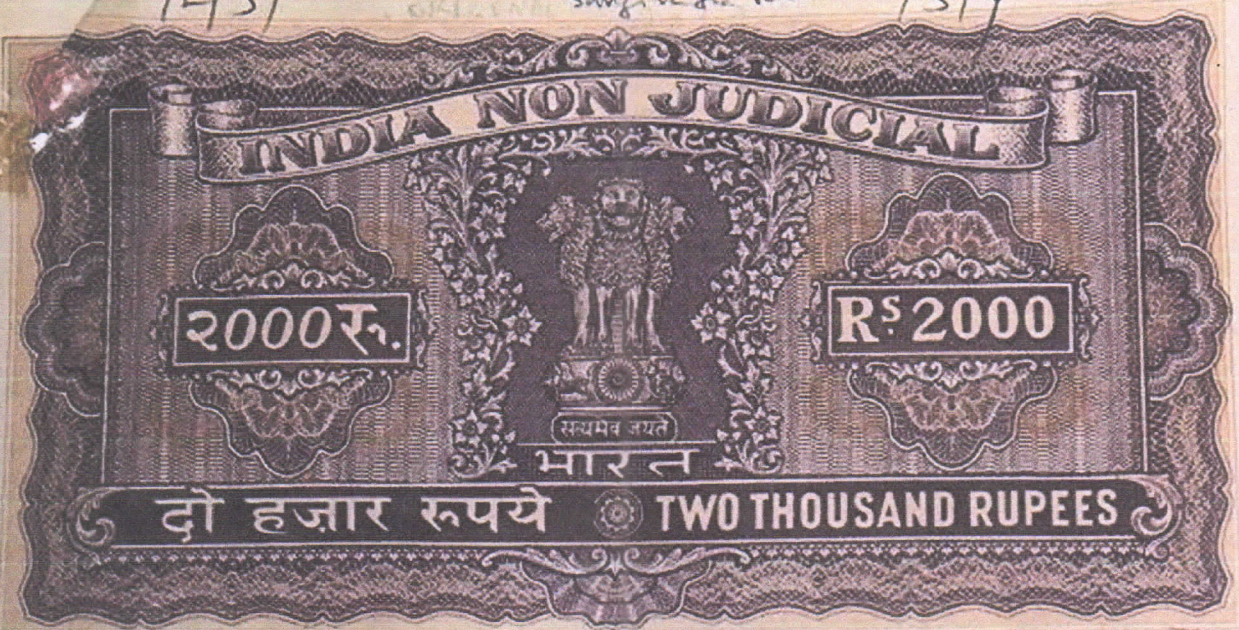

6

100

अशर

Sale

₹ 25,000

Varsha

2/2

... २० के बराबर श्री. १. १९९९

... ३ की प्राप्ति ... के ...

... के अधीन श्री ...

... १८९९ की ...

... के अधीन ...

... विमुक्त ...

... लिखित नहीं।

... १.२४

... १२५०

... १४३५

net at ...

ACD 530-25

May 27 ...

2-50

95 0-94

560-69

2/2/89

श्री. ...

...

THIS DEED OF ABSOLUTE CONVEYANCE is made on this the ___th day of January, 1989;

BETWEEN

(1) Shri Nawal Kishore Sarma, and (2) Shri Brij Kishore Sarma, both sons of Shri Pyarelal Sarma, resident of Choudhary Bagan, Upper Bazar, P.S. Kotwali, District Ranchi (here inafter called the "VENDORS") of the ONE PART;

AND

Shri Sanjivnara Nath, son of Shri Devandra Nath, resident of 214-3, Ashok Nagar, P.S. Kadra, District Ranchi, at present residing at Apt 149, 600E, Roosevelt Street, Baton Rouge, Louisiana 70802, by profession Engineer (hereinafter called the "PURCHASER") of the OTHER PART;

For Darling Housing Pvt. Ltd.

Director

contd... p/2



- : 3 : -

Land Development Corporation, sold this land to Bajna Trading Co Pvt. Ltd. having its Head Office at Calcutta, through the Managing Director Shri Danchand Bajna, son of Fushraj Bajna vide Sale De No.8075/7437 of the year, 1963 entered in Book No.1, Volume No.6 from pages 136 to 140 of the year, 1963 registered before the District Sub-Registrar, Ranchi;

AND WHEREAS the said proprietor of Bajna Trading Corp) Shri Danchand Bajna sold the said 1.25 acres of land out of 2.2 acres to the present Vendors (1) Shri Nawal Kishore Sarda, and (2) Shri Brij Kishore Sarda vide Deed No.1642, Book No.1, Volume No.72 pages 128 - 137 of the year, 1982;

AND WHEREAS the Vendors being in urgent need of money, negotiated and finalised the sale of 0.625 acre of the aforesaid land to the Purchaser Shri Sanjivendra Nath, fully described in the schedule and shown in the 'RED' wash in the map attached which is part of this Deed for a total consideration of Rs.25,000, (Rupees Twenty five thousand) only to which the Purchaser has agreed;

AND WHEREAS in pursuance of the negotiation and in consideration of Rs.25,000/- (Rupees Twenty five thousand) only, which has been paid by the Purchaser to the Vendor this date, as per memo of consideration noted below, the receipt whereof, the

contd.. p/4

27/12/82
15/12/82
15/12/82
15/12/82

For Darling Housing Pvt. Ltd.

Director

Director



- : 4 : -

Vendors doth hereby admit and acknowledge the receipt thereof and release, acquit, absolve and discharge the said Purchaser and the property from all claims in respect thereof and every part thereof, the Vendors as absolute and real owners doth hereby transfer, convey, sell and assign UNTO and TO the use of the Purchaser ALL those piece and parcel of land measuring 0.62 $\frac{1}{2}$ acre more fully described in the schedule of land given below and delineated and shown in 'RED' wash in the map attached which is a part of this Deed in perpetuity ALL the right, title & interest property, demands and claims whatsoever of the Vendor INTO and UPON the land hereby transferred absolutely to the Purchaser;

AND the Vendors doth hereby put the Purchaser in possession of the land hereby sold the Purchaser and the Purchaser shall remain in possession of the land peacefully and quietly without any hindrance from the Vendors or any person claiming through or under the Vendors and the Purchaser shall henceforth exercise ALL acts of ownership and possession of the land and shall cultivate the same, dig well on the land or construct buildings etc. or sell portion or whole of land, in fact do all that the Purchaser deems necessary;

AND the Purchaser shall be at liberty to get his name mutated wherever necessary and shall pay all the rent payable to the State of Bihar in respect of the land proportionately in his own name;

contd...p/5

श्री २१११६
१७०६ २१११६ ७१६
१७११६
१७११६

For Darling Housing Pvt. Ltd.

Director

Director

AND that this land has been shown outside the area of the Master Plan prepared by the Ranchi Regional Development Authority, Ranchi and is outside the Town Area;

Schedule of the Land:

ALL that 0.62½ acres of Raiyati land of Plot No. 3766 of Khata Nos. 166 and 353 under Khewat Nos. 2 and 19/2 of village Simalia P.S. Ratu under Kanke Anchal, District Ranchi, delineated and shown in 'RED' wash in the map attached which is a part of the Deed, rent payable for the two plots is Rs. 0.50 paise yearly; abutted & bounded as follows:-

- North : R/S Plot No. 1716;
- South : Part Plot No. 3766;
- East : Pucca Road;
- West : R/S Plot No. 3758.

Memo of consideration:

Paid Rs. 25,000/- (Rupees Twenty five thousand) only by the Purchaser to the Vendors by Cheque/Draft No.

IN WITNESS WHEREOF the Vendors have put their hands on this Deed on this the day, month and the Year first above written.

WITNESSES:

- 1. *Ranajit Kumar Singh*
2.2.89
- 2. *Gyanendra*
2.2.89

- 1. *बालकृष्ण शर्मा*
22/2/89
- 2. *श्री-श्री शर्मा*
22/2/89

Vendors.

VILLAGE SIMLIYA THANA RANCHI NO 130
PORTION OF R-S. PLOT NO 3766 AREA
62½ DECIMAL SHOWN IN RED WASH
SCALE 16" = 1 MILE

SANCTIONED MAP

ORIGINAL

Certified that original and Dupli-
cates are exact true to each other.
MAM 3008

S

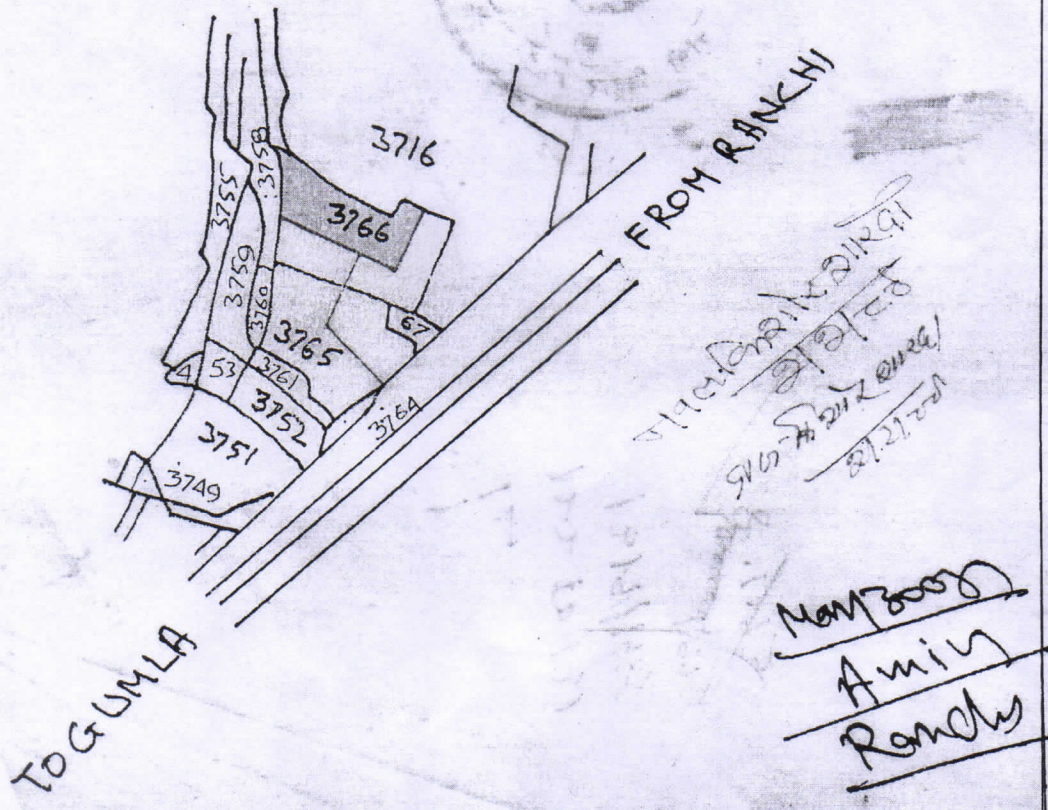

Sch XIV- F.No. 180v

रसीद मालगुजारी

नाम सर्कल । नाम मौजा मय

थाना वो थाना नम्बर

फरद मलकी / फरद रैयती

नाम रैयत मय वलियत जमाबन्दी

वो सकुनत नम्बर।

Page No. : 129

Vol. No. : 11

Receipt No. : 0528293043

रातु | सिमलिया | 139 | संजीववेन्द्र नाथ

खाता संख्या	खेसरा संख्या	रकबा (एकड़ में)
166	3765	0 कठा 62.5 डिसमील 0 सेंटीमीटर

अराजी नकदी	अराजी भावली	तफसील हिसाब लगान भावली
------------	-------------	------------------------

जोत का सालाना मांग मय तफसील (बकाया वो हाल) मौजूदा साल का।

मांग बावत	सालाना	बकाया				हाल (2022-2023)
		तीन वर्ष से ज्यादा (1990-1991) - (2018-2019)	3 रा वर्ष (2019-2020)	2 रा वर्ष (2020-2021)	1 ला वर्ष (2021-2022)	
माल (नकदी)	0.50	14.50	0.50	0.50	0.50	0.50
गुजारी (भावली)	0.12	3.48	0.12	0.12	0.12	0.12
सेस	0.25	7.25	0.25	0.25	0.25	0.25
सूद	0.25	7.25	0.25	0.25	0.25	0.25
मुतफरकात	0.10	2.90	0.10	0.10	0.10	0.10
मीजान	1.22	35.38	1.22	1.22	1.22	1.22

तफसील अदायकारी

अदायकारी बावत	बकाया				मोतालबा हाल (2022-2023)	फाजिल
	तीन वर्ष से ज्यादा (1990-1991) - (2018-2019)	3 रा वर्ष (2019-2020)	2 रा वर्ष (2020-2021)	1 ला वर्ष (2021-2022)		
माल (नकदी)	14.50	0.50	0.50	0.50	0.50	
गुजारी (भावली)	3.48	0.12	0.12	0.12	0.12	
सेस	7.25	0.25	0.25	0.25	0.25	
सूद	7.25	0.25	0.25	0.25	0.25	
मुतफरकात	2.90	0.10	0.10	0.10	0.10	
मीजान अदायकारी	35.38	1.22	1.22	1.22	1.22	

(1) मीजान कुल (लफजों में) : Forty Rupees and Twenty Six Paise

(2) नाम देहिन्दा -

(3) कुल बकाया- 40.26

तारीख अमला तहसील कुनिन्दा : 17-10-2022

खास महाल का बकाया मालगुजारी पर (सिवाय ऐसे बकायों पर जिन पर कि सर्टिफिकेट जारी हो) सूद नहीं लिया जाता है।



यह एक कम्प्युटर जनित प्रति है।

यह प्रपत्र केवल प्रार्थी की जानकारी के लिए है।

किसी भी प्रकार की अशुद्धियों के लिए सम्बन्धित अंचलाधिकारी से संपर्क करें।

दो गज की दूरी का रखो ध्यान यही है कोरोना का समाधान ।

Print

For Darling Housing Pvt. Ltd.

Director

Darling

Director

आपका पता - ...

आपका पता - ...

दि. १०. १०. १९७१

Darling

क्र. सं.	आपका पता	आपका पता	आपका पता	आपका पता	आपका पता	आपका पता	आपका पता	आपका पता
1
2
3
4
5
6
7
8
9
10

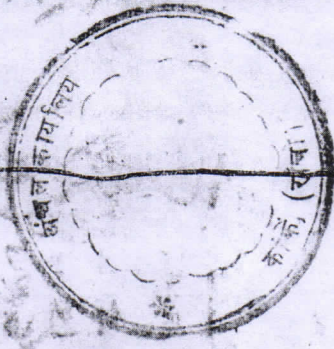

आपका पता - ...

आपका पता - ...

...

...